

Shank Types

Morse Taper Shank to Din 228 (Part B)

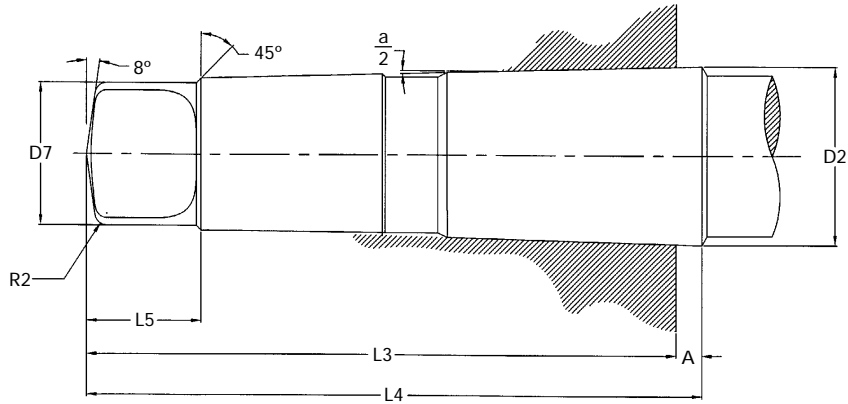
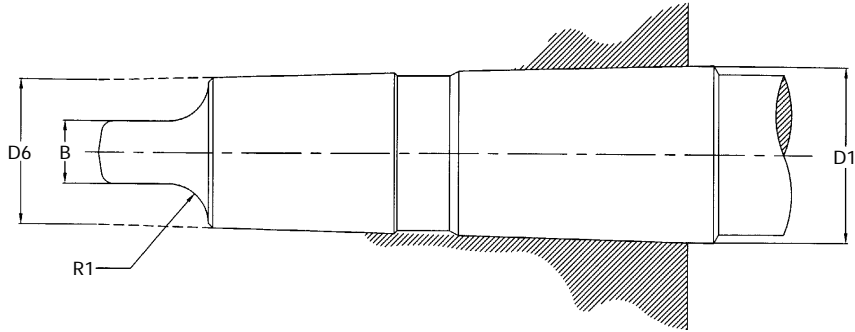

Morse taper number	a/2	A	B	D1	D2	D6	D7	L3	L4	L5	R1	R2
0	1° 29' 27"	3.0	3.9	9.045	9.2	6.1	6.0	56.5	59.5	10.5	4	1.0
1	1° 25' 43"	3.5	5.2	12.065	12.2	9.0	8.7	62.0	65.5	13.5	5	1.2
2	1° 25' 59"	5.0	6.3	17.780	18.0	14.0	13.5	75.0	80.0	16.0	6	1.6
3	1° 26' 16'	5.0	7.9	23.825	24.1	19.1	18.5	94.0	99	20.0	7	2.0
4	1° 29' 15"	6.5	11.9	31.267	31.6	25.2	24.5	117.5	124.0	24.0	8	2.5
5	1° 30' 26"	6.5	15.9	44.399	44.7	36.5	35.7	149.5	156.0	29.0	10	3.0
6	1° 29' 36"	8.0	19.0	63.348	63.8	52.4	51.0	210.0	218.0	40.0	13	4.0